

Simpson Mix-Muller®

In small- to medium-sized sand systems or difficult mixing applications, versatility is critical. The Mix-Muller has been carefully designed and proportioned to achieve maximum performance, versatility and energy efficiency in these types of applications.

Description

Medium-speed, high-intensity, muller-type mixer for batch operation.

Application

Small- to medium-sized sand preparation systems, and the most difficult mixing applications.

Features

- Adaptive tooling
- Energy efficiency
- Large batch and longer available cycle
- Rugged design

Upgrades

- Abrasion Resistant Polyurethane Liners
- Abrasion Resistant Polyurethane Wheels with Wear Indicators

Versatility

Adaptive Tooling. Muller wheels are mounted on independent, springloaded suspensions. As the molding sand mixture increases in volume and strength, the mullers react by raising and increasing the mulling pressure. This is a versatile and inexpensive source of mixing energy which provides the kneading and compression action of mulling.

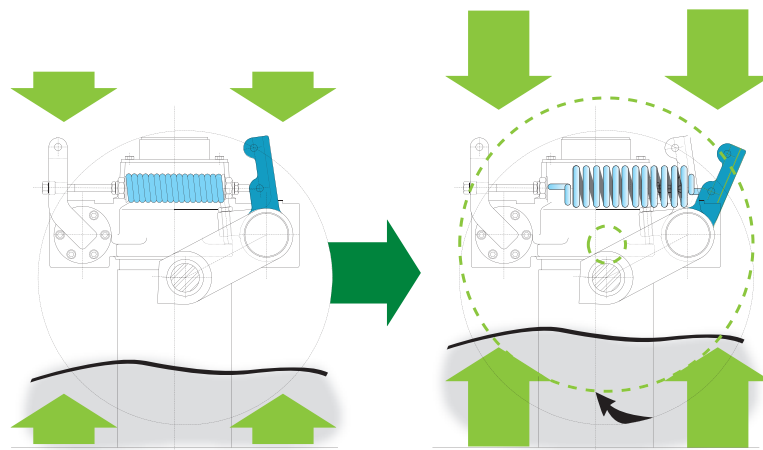

Simpson Mix-Muller Technical Data - G Series

| Model | | LF | 05 | 1F | 1 1/2G | 2G | 2 1/2G | 3G | 6G |
|-----------------|---------------|-------|-------|-------|--------|-------|--------|--------|--------|
| Batch Capacity | kgs | 20 | 135 | 240 | 560 | 1,130 | 1,630 | 2,260 | 3,810 |
| OUTPUT | at 120s cycle | | | 7 | 17 | 34 | 49 | 67 | 114 |
| | at 180s cycle | | | 5 | 11 | 23 | 33 | 45 | 76 |
| Crib Diameter | mm | 610 | 990 | 1,270 | 1,625 | 2,030 | 2,300 | 2,560 | 3,050 |
| Crib Height | mm | 230 | 305 | 460 | 835 | 980 | 980 | 1,110 | 1,070 |
| Height | mm | 1,000 | 1,350 | 1,670 | 2,960 | 3,560 | 4,260 | 4,600 | 5,200 |
| Width | mm | 795 | 1,020 | 1,430 | 1,720 | 2,130 | 2,400 | 2,650 | 3,820 |
| Length | mm | 975 | 1,190 | 1,560 | 2,120 | 2,715 | 2,915 | 3,150 | 3,550 |
| Drive Motor | HP | 1 | 3 | 10 | 20 | 50 | 75 | 125 | 200 |
| | kw | 0.7 | 2.2 | 7.5 | 15 | 37 | 56 | 93 | 150 |
| Exhaust | m³/hr | | | 1,120 | 1,840 | 3,400 | 4,590 | 6,800 | 10,200 |
| Shipping Weight | kgs | 340 | 635 | 1,430 | 3,675 | 5,900 | 9,670 | 12,040 | 19,050 |

All figures are approximate and are subject to change depending upon your application.

Batch Mulling

Designed to utilize larger batch sizes and longer cycle times to provide better consistency and control. Larger batch sizes provide for better averaging of multiple molds and other variations in return sand. Longer cycle times provide for better control. Adaptive tooling provides for flexibility to adjust to variations in batch composition and property development.

1 Wide-faced mullers provide compression and shear. The muller wheels are set slightly off their true radius so that as they revolve, they skid to provide a shearing action. The inside edges of the wheels travel a shorter path than the outside of the wheels which causes a spatulating action across the face of the wheels.

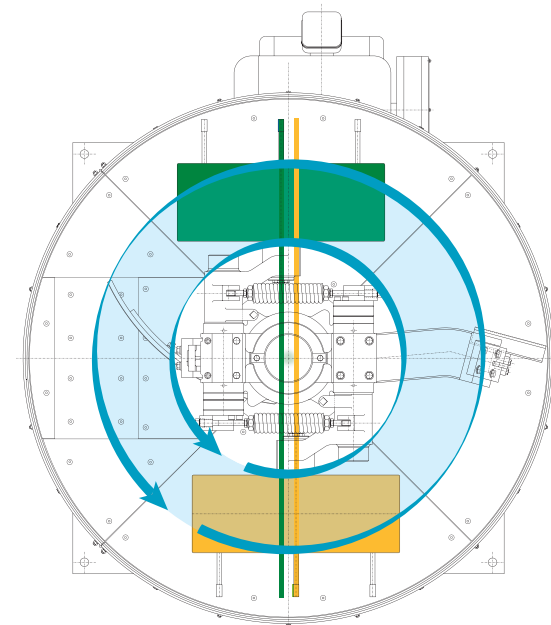

2 Interchangeable, modular plows armored with tungsten carbide provide intensive blending and minimize maintenance costs.

